

# Part Number: F07320

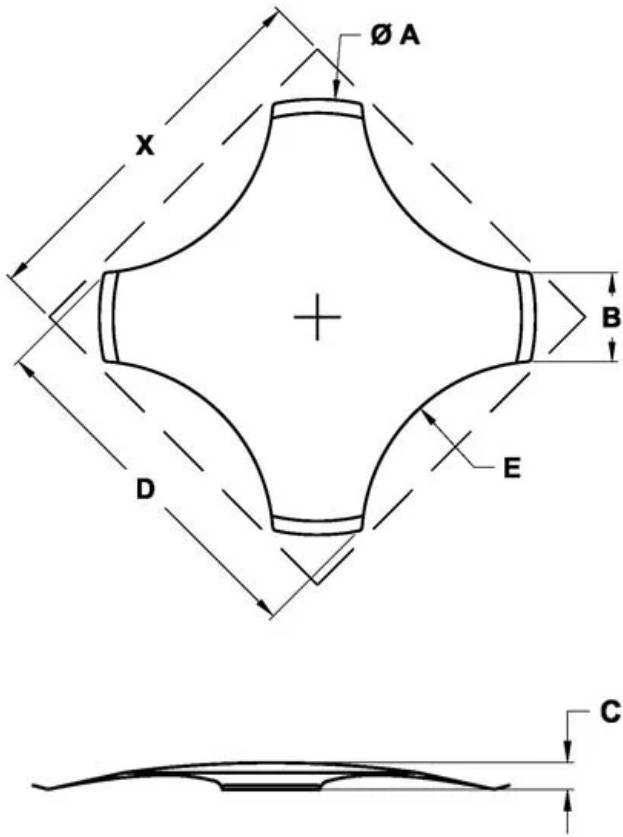

Dim. A	7mm (0.276")
Dim. B	1.40mm (0.055")
Dim. C	0.46mm (0.018")
Dim. D	5.84mm (0.230")
Dim. E	2.87mm (0.113")
Dim. X (dome cavity)	6.35mm (0.25")
Fmax/Force	320g +/- 30g, typical
Life Cycles	up to 5,000,000
Dimple	No
Contact Configuration	SPST N.O.
Switching Voltage	0.1 to 50 VDC
Switching Capacity	1 Watt
Switching Current	0.05 to 100 mA DC
Contact Bounce	<0.3ms make <0.6ms break
Base Material	SSTL
Plating	Nickel/Silver/Gold optional
Operating Temp Rating	-45 degrees C to +100 degrees C
Storage Temp Rating	-55 degrees C to +100 degrees C